

極低頭小頭ボルト

代表品番 **K3EH**

概要 鋼製（三価クロメート）

詳細 ■材質：SCM435 ■強度区分：10.9 ■駆動部の形状：六角穴

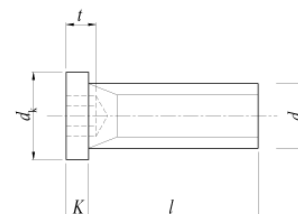
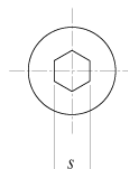

d	M3	M4	M5	M6	M8	M10	
d_k	4.5	5.5	7	8.5	10	13	
k	1.3	1.5	1.5	1.5	1.5	1.5	
s	1.5	2	3	3	4	5	
t_{max}	2	2.5	3	4	5	5	
l	5	K3EH0305					
	6	K3EH0306	K3EH0406				
	8	K3EH0308	K3EH0408	K3EH0508	K3EH0608		
	10	K3EH0310	K3EH0410	K3EH0510	K3EH0610	K3EH0810	
	12	K3EH0312	K3EH0412	K3EH0512	K3EH0612	K3EH0812	K3EH1012
	16		K3EH0416	K3EH0516	K3EH0616	K3EH0816	K3EH1016
	20		K3EH0420	K3EH0520	K3EH0620	K3EH0820	K3EH1020
	25			K3EH0525	K3EH0625	K3EH0825	K3EH1025
30					K3EH0830	K3EH1030	